

STAINLESS STEEL TABLE WITH CABINET & DRAWER

[Stainless steel table with cabinet](#) is designed with knee space and can be used for maximum storage, too. Stainless steel countertops, base cabinets, wash areas, sinks are perfect for facilities requiring sanitizing and sterilization. Our stainless steel casework have the same construction detail as our steel cabinets.

Call now! +86-13302388256



STAINLESS STEEL WORK TABLE WITH CABINET

Application:

Appropriate for laboratory, research, medical device, microelectronic, or pharmaceutical processes, etc.

Structure:

304ss base cabinet, 304ss countertop, 304ss wash area;

Phone: +86-13302388256

Email: info@zhlabsfurniture.com

Address: No.3068, Liangsha Road, Chendong Village, Zhongluotan Town, Baiyun District, Guangzhou City, Guangdong Province, China

Easy-to-clean design is ideal for applications that require frequent wipe-downs. Smooth, continuous-seam welds also eliminate cracks and crevices that can harbor contaminants.

Base Casework:

Provides effective and easily accessible storage space underneath your workstation for a clean and tidy lab

Design:

Each cabinet with doors and drawers and adjustable shelf ensuring easy storage;

Standard Base Cabinet: (Provided without locks)

Standard cabinet is made by 304 stainless steel, W850mm

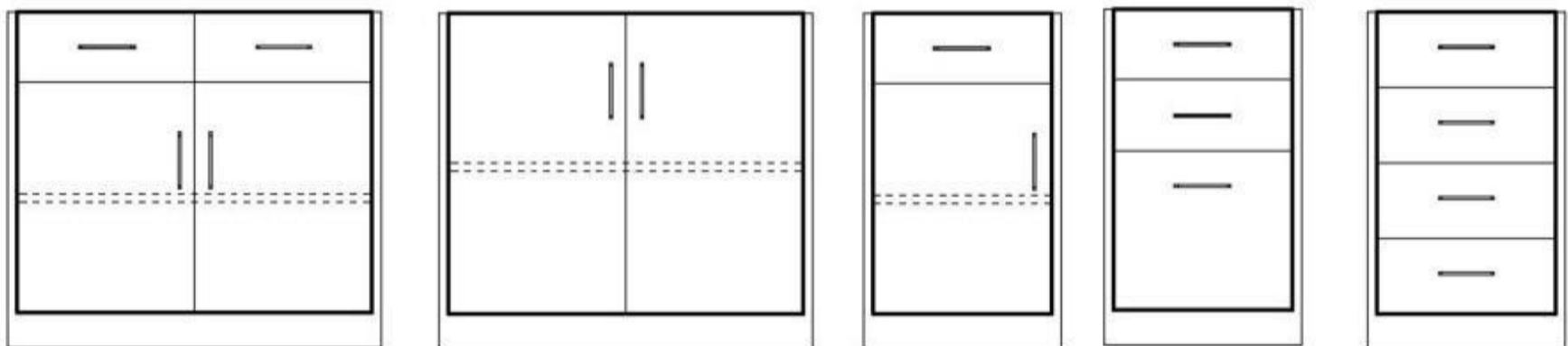

Standard cabinet is made by 304 stainless steel, W850mm-double doors, W450mm-single doors;

Material:

Entirely cabinet is made by 304 stainless steel, heavy duty-700lbs;

Welding:

All cabinet component parts are of the sectional units are manufactured ensuring strength and shipment save;

Doors and Drawer Front:

Double wall structure, sound deadened;

Countertops:

304 Stainless steel standard;

Epoxy resin for optional; Epoxy-resin top work station resists common organic compounds, acids and solvents.

Adjustment:

Smooth, chemical resistant, and adjustable Nylon leveling feet for stability on uneven floors.



Stainless wash area include 304ss sink and water tap. The one-piece sink specification is approx. 500*400*300mm, with round corner. 304ss Water taps can be only cold or cold with hot mixer.

STAINLESS STEEL WORK TABLE WITH CABINET OPTIONAL

Benchtop shelves: The main frame is made of 304 stainless steel with 1.2mm thickness. The shelf is made of reinforcing glass with 12mm thickness and stainless steel tube to be guardrail. The shelves can be adjustable.

Pegboard: PP pegboard in black color, stainless steel pegboard in its color;

Eyewash: deck mounted eyewash beside water for emergency first aid.

FAQ:

Is OEM acceptable for stainless steel lab table?

Sure, the although the base casework is modular,